

REVISIONS					
ISS #	ECO #	REV	DESCRIPTION	DATE	APPROVAL
		-1	PRELIMINARY		

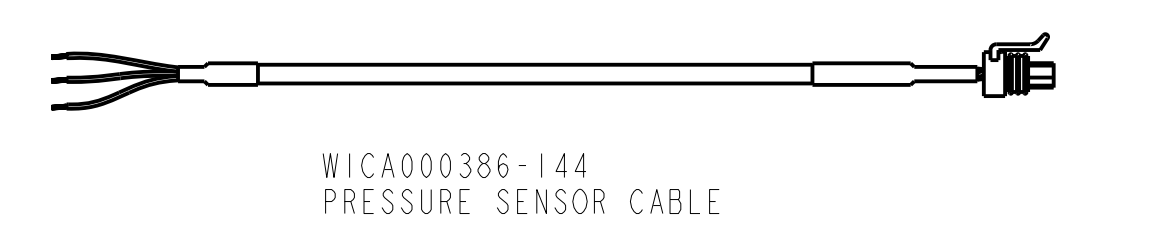
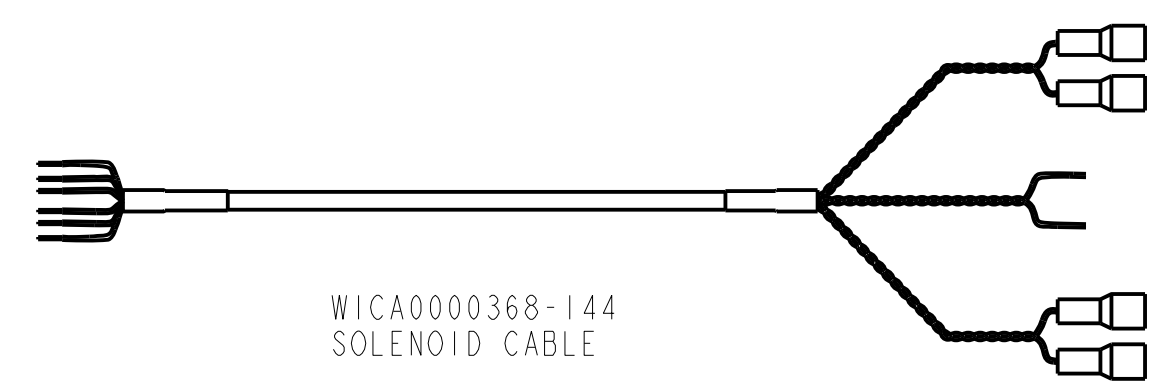
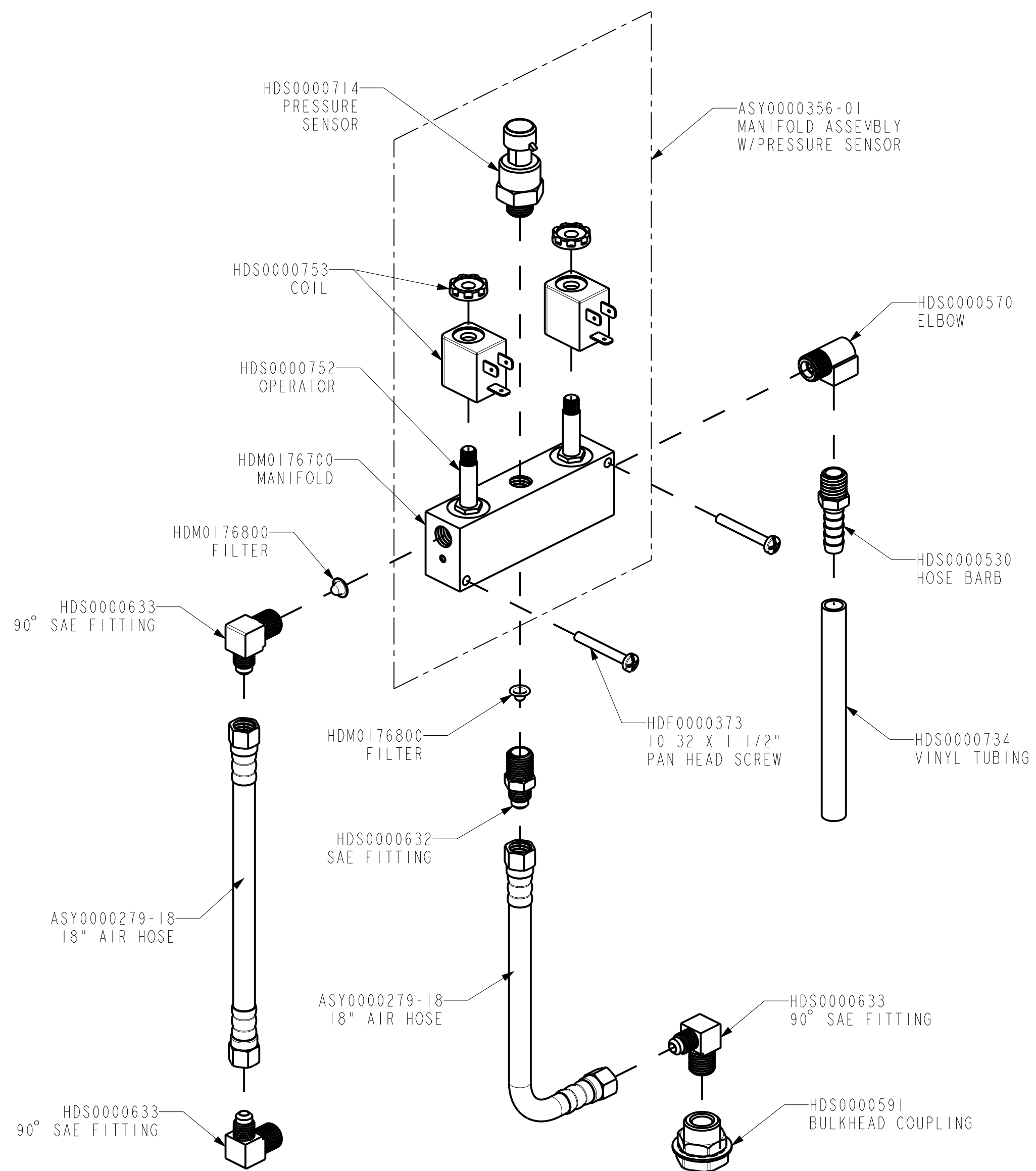

QTY	PART/ASSEMBLY	DESCRIPTION	DRAWING	ITEM
1	WICA000386-144	ASSY CABLE PRESSURE SENSOR UNTERMINATED	996129	12
1	WICA000368-144	ASSY SOLENOID CABLE UNTERMINATED	247043	11
1	HDS0000734	3/8 CLEAR VINYL TUBING	996052	10
3	HDS0000633	BRASS 90 1/4 NMPT X -4MSAE	997944	9
1	HDS0000632	BRASS 1/4 NMPT X -4MSAE	997943	8
1	HDS0000591	BULKHEAD COUPLING 1/4 IN BRASS F IPT	997895	7
1	HDS0000570	ELBOW 1/4 MALE TO 1/4 FEMALE	997799	6
1	HDS0000530	HOSE BARB ADAPTER 3/8 BARB X 1/4 MIP	997776	5
2	HDM0176800	WIRE MESH FILTER	247089	4
2	HDF0000373	SCREW 10-32 X 1-1/2 CMB PN HD SS HARDWARE	998858	3
1	ASY0000356-01	ASSY DUAL SOLENOID MANIFOLD W/PRESS SENSOR	247066	2
2	ASY0000279-18	ASSY AIR HOSE 18"	240156	1

APPROVALS		DATE
DESIGNER:		
DRAWN BY:		
CHECKED BY:		
OTHER:		
NOTICE OF PROPRIETARY AND CONFIDENTIAL PROPERTY THESE DRAWINGS AND SPECIFICATIONS ARE THE PROPERTY OF PROTEL, INC. AND SHALL NOT BE REPRODUCED, COPIED OR USED AS THE BASIS FOR MANUFACTURE OR SALE OF ANY APPARATUS WITHOUT THE EXPRESS WRITTEN AUTHORIZATION FROM PROTEL, INC.		
UNLESS OTHERWISE SPECIFIED ALL DIMENSIONS ARE IN INCHES [MM] FRACTIONS    DECIMALS    ANGLES : 1/16    .XX : .01    : .5° .XXX : .005		
MATERIAL	FINISH	

**Protel**<sup>®</sup>  
Innovation is our business

KIT MANIFOLD AS7  
DIGITAL AIR

C	PART NUMBER	DRAWING NUMBER	DWG REV
	KIT0000604-00	BOM ONLY	- 1
SCALE	CAD FILE	SHEET	OF
1:2	KIT604-00	1	1